

Fire Advice

for flats and high-rises

General advice for fire prevention
and what to do in the event of a
fire in or near your home

This can be made available in braille, large print,
and audio.

What to do in the event of a fire in a flat or high rise building

- **If the fire is in your flat then:**

Only tackle the fire if it is safe to do so. If the fire is bigger than a waste paper bin, or smoke is making you cough, then do not tackle it.

Instead, leave your belongings behind and get out! Stay out!

Take everyone else with you, leave the room and your flat, and close all doors behind you. If there is a lot of smoke, crawl as near to the ground as possible as you will breathe more easily.

Ring the Fire Service on **999** and follow their advice.

Do not open any doors which are warm when you touch them with the back of your hand, as the fire is probably behind them.

If you need to leave the building then use the stairs. Do not use the lift.

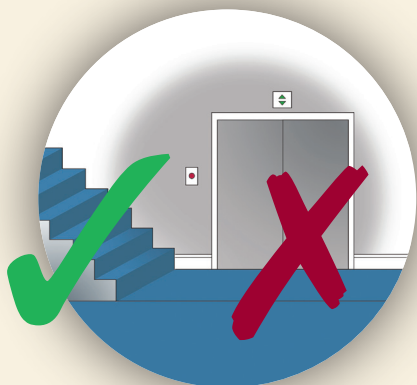

- **If there is a fire in another flat then:**

Stay in your flat but close the doors to prevent smoke from entering.

Ring the Fire Service on **999** and follow their advice - leave if they tell you to do so or if a lot of smoke enters your flat and starts to make you cough.

If you need to leave the building then use the stairs, not the lift.



- **What if you can not get out of your flat because of the fire?**

Get everyone into one room and close the door. Smoke and fumes can kill people quickly so put bedding and wet towels along the bottom of the door to seal the gap.

Open the window and stay near it for fresh air and to make sure that the fire fighters see you.



Ring the Fire Service on **999** and clearly tell them where you are - if you can not speak to the Fire Service then, try to signal so that people outside can see you.



- **What about escaping from a window?**

If you are near the ground floor and you are able to escape, throw soft bedding out of the window to break your fall and lower yourself (and others as far as possible down before dropping to the ground. Cover any broken glass with bedding to prevent injury.



- **Do not go back into your flat once you have left**

Even if you have left personal belongings or pets behind, once you have left your property then you should never go back. You should only return when the Fire Service tells you that it is safe to do so.

How to keep safe and prevent fires

- **Whatever you do - do not obstruct escape routes**

Your building has been designed with fire safety in mind. The walls and doors between flats, stairs and corridors are specially designed to resist fire and stop the spread of smoke.

When they are not in use:

- Fire doors must not be propped open.
- Escape routes must be kept clear.
- Stairs and corridors must be kept clutter free.
- Trip hazards and materials that burn or smoke easily must be removed.

Please remember that when you share a building with other people, your safety and theirs depends on everyone co-operating. As a resident of the building, you are responsible for making sure that areas are kept clear of obstruction and materials that can be easily set on fire.



If in doubt, or you want to report anything of concern then call Bron Afon on **Freephone 0800 111 42 42**.
For a free home fire safety check, call **0800 169 1234**.

• **Fire alarm testing**

All communal alarms will be regularly checked and serviced by Bron Afon staff. However, if you have an alarm within your flat which has a test button, then we recommend that you test these weekly.

Do not disconnect any alarms as this puts you and others at risk.

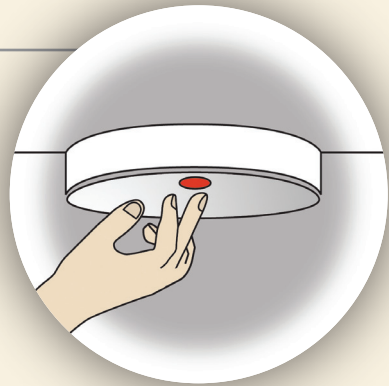

• **Develop a Fire Escape Plan**

Think about how you would get out in the event of a fire and ensure that everyone knows the plan. Make sure that you do not block hallways and that everyone in your home knows where keys to windows and doors are kept.

If you are disabled or hearing impaired, your Community Housing Officer can discuss with you any special help or support you may need in the event of a fire.

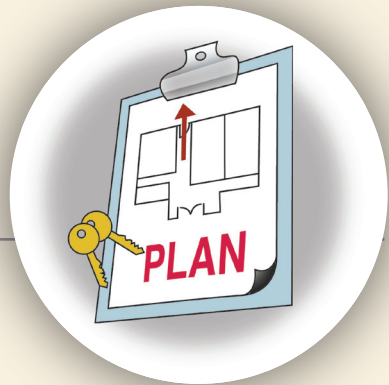

• Fire prevention

Reduce the risk of fire by not leaving candles or chip pans unattended.

Avoid smoking in bed and check that all cigarettes are put out.

Where you can, make sure that you switch off electrical appliances before going out or to bed.

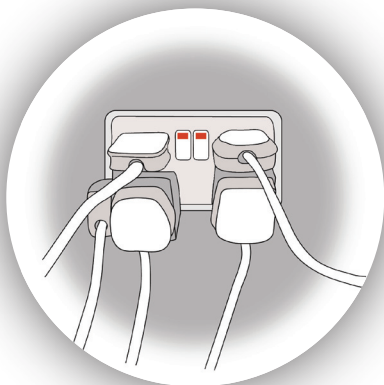
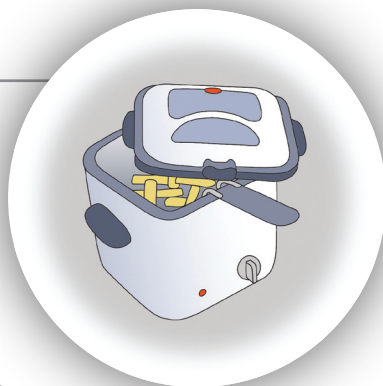

Do not over-load plug sockets.

Make sure that all your heating appliances are serviced regularly and are kept away from any furniture and soft furnishings.

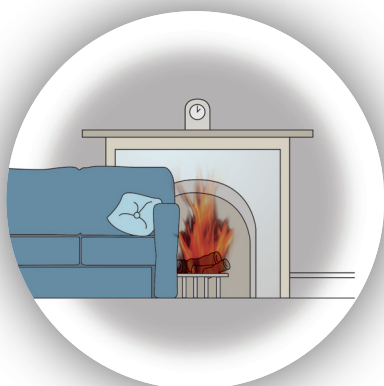

Bron Afon Community Housing Limited

Tŷ Bron Afon

William Brown Close

Llantarnam Industrial Park

Cwmbran

Torfaen NP44 3AB

Phone: **01633 620 111**

Email: enquiries@bronafton.org.uk

bronafton.org.uk

Download the My Bron Afon App on your appstore